

FOOD & DRINK

RB Group to deliver new high capacity packaging line for Gü

Gü and RB Group work together to deliver a new high capacity production line with just a few days downtime of existing facilities.

BACKGROUND

RB Group has been working closely with Gü and specialist suppliers to deliver a new high speed multi format packaging line as part of a multi-million pound investment in the Gü Bishops Stortford site.

The total project investment that RB is managing for our client is nearly £40M.

Read about the groundbreaking 3D software we used on this project at rbplant.com/case-studies



PROJECT SCOPE

- ✔ High-care ambient food storage warehouse
- ✔ New compressor building and system
- ✔ New building for a 5 channel CIP system
- ✔ New bulk chemical system including distribution and satellite stations
- ✔ New high speed ultra clean (ISO7) production line (liquid and particulate depositing)
- ✔ New steam boiler and steam distribution system
- ✔ New high speed multi format packaging line
- ✔ New (ISO7) mixing hall including powders handling and ATEX zones
- ✔ New multilevel site utilities building including 5 air handling plants (for ISO7 & 8 production areas), and a new large ammonia plant
- ✔ New chilled warehouse
- ✔ New fully automatic bulk chilled, warm and powders systems supplying the mixing hall



THE SOLUTION

The entire line will be assembled and run at high speed during a full FAT and PUWER assessment at the OEM facility in Ireland. The line will then be carefully disassembled, shipped to the UK and installed at the Gü Bishops Stortford site.

Read about the groundbreaking 3D software we used on this project at rbplant.com/case-studies



CHALLENGES AND ACHIEVEMENTS

- Successful management of programme and stakeholder engagement
- Management of all circa 120 suppliers on the project including numerous different European suppliers.
- CDM for the site
- Engineering (Mechanical, Civil/Structural, Process, E&C) etc
- All process oversight including: ATEX, automation, check-weighing, coding/labelling, conveying, filling, palletising, container filling, powder handling, powder storage, primary packaging, secondary packaging, solids handling, tertiary packaging, weighing
- All civil engineering including: clean areas, drainage, fit-out, hygienic flooring/surfaces, warehousing, foundation/piling design.
- Managing planning applications, building control, noise surveys and acoustic design work.
- Detailed 3D scanning of the entire site
- Managing FAT's (across Europe) and SAT's
- Undertaking PUWER assessments
- All surveys, design federation and site wide 3D modelling
- Principal Designer
- Principal Contractor

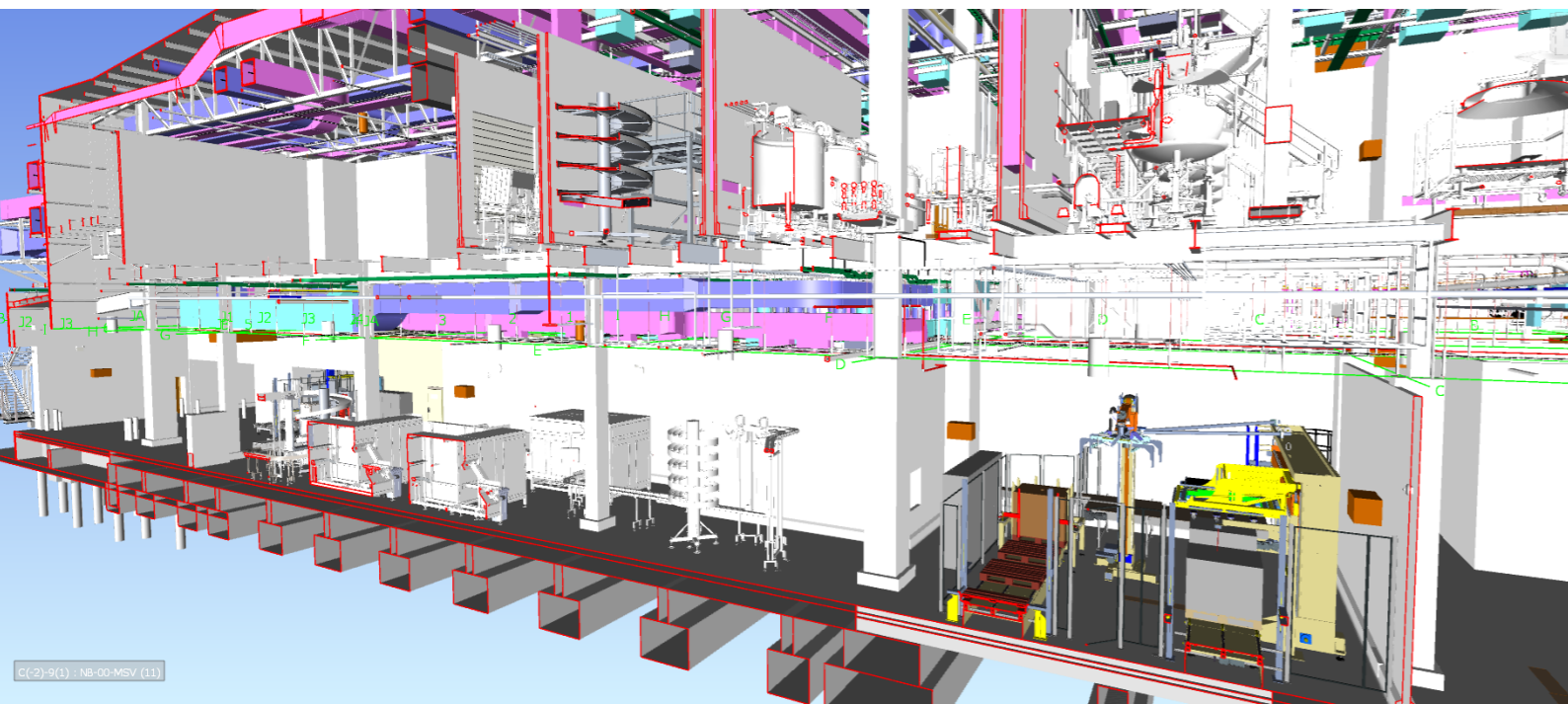

THE BENEFIT

The new packaging line includes the **latest advanced technology** and will enable Gü to **continue to innovate** and bring the most irresistible chilled treats to consumers around the world.



ABOUT RB GROUP

RB Group provides professional engineering consultancy, design, project, and construction management services across a wide range of sectors from Pharmaceuticals to Heavy Engineering – applying vision, purpose, and cutting-edge expertise.

We undertake every stage of a project lifecycle from initial conception to commissioning, both globally and within the UK.

Our highly skilled and qualified Process, Mechanical, Civil and Structural, HVAC, CDM, Electrical, Control & Instrumentation Engineers undertake engineering projects of all sizes. These range from smaller scale projects such as plant modifications, expansions,

and upgrades, through to multi-million construction projects. We apply the same levels of client focus and professionalism to every project, regardless of size.

Our high proportion of repeat business coupled with an organically growing new customer base is no accident and reflects our unique approach that make us stand out in the market-place.



FIND OUT MORE

- ✔ Our experienced engineering team could support you on your next project. Why not contact Genghis Perriman our Business Development Manager to discuss further for a no-obligation discussion?

Phone
01622 858387

Email
mail@rb-plant.co.uk

 rbplant.com



RB PLANT CONSTRUCTION LTD.

RB House The Square Lenham Maidstone Kent ME17 2PG

+44 (0) 1622 858387

mail@rb-plant.co.uk

rbplant.com